

BIGGER IN TEXAS

  
**Riley Blake**  
DESIGNS



 *Bluebonnet Breeze*  
by Shealeen Louise

# BIGGER IN TEXAS QUILT



Finished quilt: approx. 46" x 46"

©2022 Riley Blake Designs.

Fabric: Bluebonnet Breeze by Shealeen Louise for Riley Blake Designs

## INSTRUCTIONS

Please read through all the directions first before starting and assume 1/4" seam allowance. Sew with right-sides together unless otherwise stated. Press all seams in the direction of the arrows on the diagrams. Yardage is based on a 42" width of fabric.

WOF: Width of Fabric

LOF: Length of Fabric

RST: Right sides together

SNF: Stitch and Flip

This quilt pattern is a beginner level quilt pattern. Basic knowledge of quilt piecing techniques and terminology is required. Please visit our website at [www.rileyblakedesigns.com/pattern-updates](http://www.rileyblakedesigns.com/pattern-updates) to check for any updates before beginning this project. Have fun!

## FABRIC REQUIREMENTS

- 5/8 yard Cobalt Tonal (C11644 )\*
- 2/3 yard White Main (C11640)
- 1/3 yard Sky Monarch (C11641)
- 1/3 yard Sky Tonal (C11644)
- 1/3 yard Sky Main (C11640)
- 1/3 yard Sky Flowers (C11642)
- 5/8 yard of Riley White Confetti Cotton (C120)

\*includes binding

## CUTTING DIRECTIONS

### Cobalt Tonal



Cut (4) 5 1/2" squares (cornerstones)

Cut (5) 2 1/2" x WOF strips (binding)

### White Main



Cut (4) 5 1/2" x 36 1/2" rectangles (border)

From EACH of the Following prints:

### Bluebonnet Breeze: Sky Monarch; Sky Tonal; Sky Main and Sky Flowers



Cut (2) 10" squares of EACH print.

### Riley White Confetti Cotton



Cut (4) 9 1/2" squares

Cut (4) 10" squares

## TEXAS STAR BLOCK DIRECTIONS

1. Gather (1) 10" square of EACH of the following print fabrics: Sky Monarch; Sky Tonal; Sky Main and Sky Flowers. Using the diagram to match the prints, place (2) prints RST. Draw a diagonal line from corner to corner as shown. Sew a scant 1/4" seam allowance on EITHER side of the drawn line. Trim along the drawn line to make (2) HSTs. Press towards the darker print and trim the HTS to 9 1/2" square. Repeat for the remaining (2) prints to equal a total of (4) print on print HSTs. Press and trim.

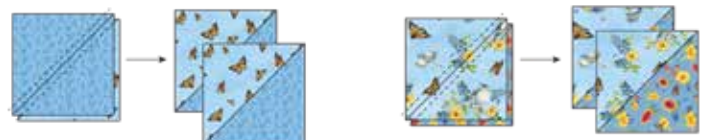

# BIGGER IN TEXAS QUILT

- Repeat the 2-at-a-time HST method above using the remaining 10" print squares each with a 10" white square as the 2<sup>nd</sup> square for each HST. This will equal a total of (8) print on white HSTs. Press and remember to trim each HST to 9 1/2" square.

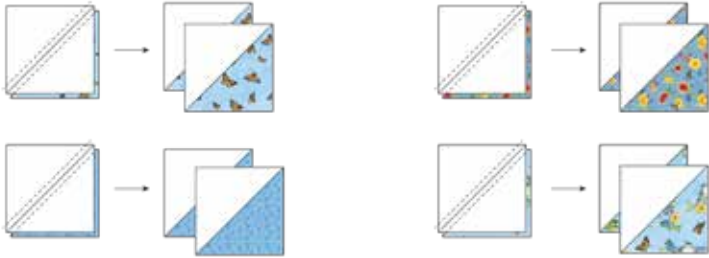

- Using your design wall or an open space on the floor, layout the HSTs from step 1 and 2 to match the corresponding diagram. Add (4) 9 1/2" white squares to the corner of the Star. You will have (4) rows of (4) blocks each. Note the rotation and placement of the fabrics and HST units.

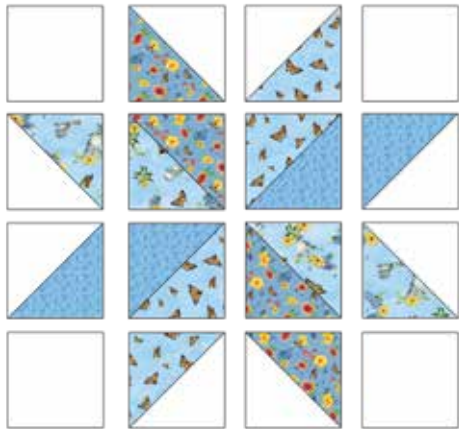

- Pin and sew each horizontal row together. Press seams in the direction of the arrows.

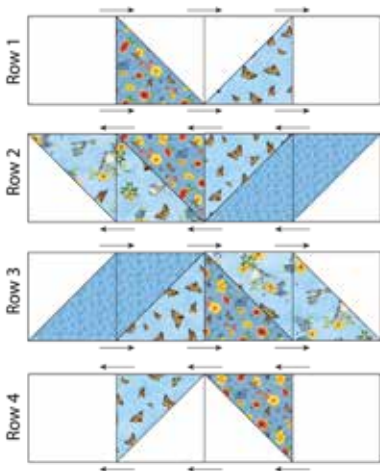

- Next, pin and sew the vertical rows together starting with row 1 to row 2 and row 3 to row 4 making sure all the points and intersections are matching. Then pin and sew row 2 to row 3. Press all horizontal seams downward. The Star should measure 36 1/2" x 36 1/2" square.

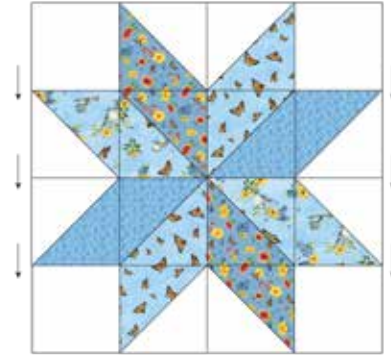

## ASSEMBLE THE QUILT

- To assemble the border, take (2) 5 1/2" x 36 1/2" border rectangles and pin and sew on either horizontal edge of the Star Block. Press seams in the direction of the arrows.
- Next take (2) cornerstone blocks and sew them on either side to (1) border rectangle to prepare the horizontal border strip. Make 2. Pin and sew the top and bottom borders to the quilt top. Press seams in the direction of the arrows.

The Bigger in Texas quilt top should measure 46 1/2" x 46 1/2".

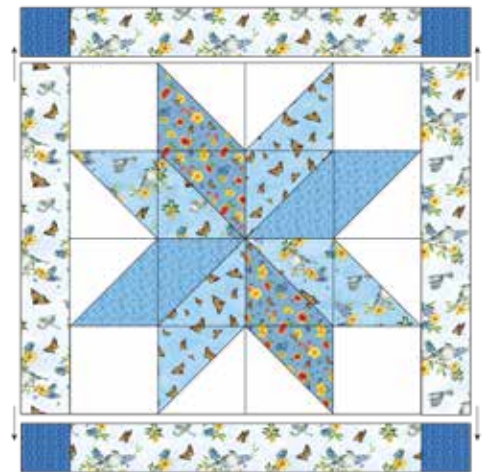

Layer your backing, batting and quilt top. Quilt as desired. Bind the edges with your favorite binding method using the prepared binding. Enjoy and share your quilt using the hashtags [#bluebonnetbreezefabric](#) [#biggerintexasquilt](#) [#rileyblakedesigns](#) [#iloverileyblake..](#)